

# County Councillors Report June 2024.

## Groby Flood Alleviation work, Leicester Road, update.

### Update for Dalby Drive & Marston Drive

I am working closely with Severn Trent and Highways on both of these schemes, and I would like to share Severn Trent's update with residents, Once again, a big thank you for your patience from both myself and Severn Trent as they work to reduce the flood risk in Groby. Following on from their last letter to residents, there have been more changes to the programme. Here is their update.

For health and safety reasons we've been unable to reopen Marston Drive as planned so this will now reopen on or around 14 June.

Work begins on the section across Dalby Drive from Tuesday 27 May.

- This will take around three weeks to complete.
- Leicester Road will continue to be a single lane between Grey Close and Marston Drive with traffic lights at the top and bottom of the hill.
- Traffic on Dalby Drive will be managed by traffic lights
- The access from Dalby Drive to Leicester Road has to be closed for safety reasons due to the road layout and where we can position the lights and signage.
- Residents from 112 – 120 Leicester Road must use Leicester Road for access and not Dalby Drive.

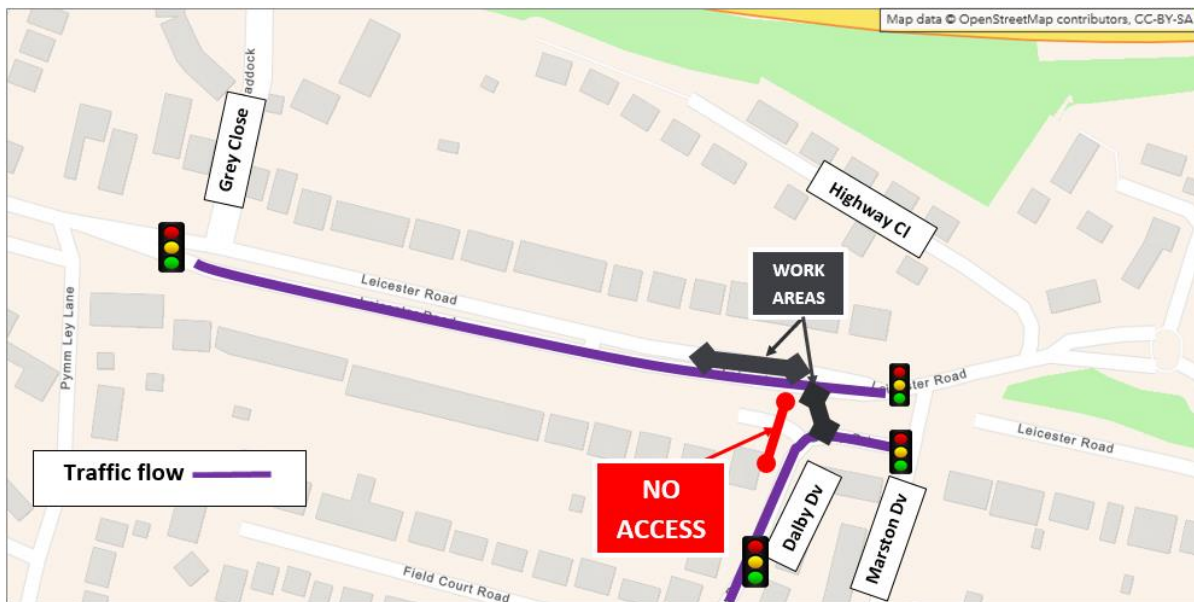

All locations are approximate

Working with Severn Trent and residents. I can confirm there's now a pedestrian access from Dalby Drive to Leicester Road along that cut through:

## We're planning work on Ratby Road

### **What are we doing?**

As you know, Groby village has suffered from foul and surface water flooding for several years. We've already installed the storage pipes on Leicester Road that will hold excess surface water when it rains heavily and send it slowly back into the waste-water network.

The next phase is to install new pipes that will separate surface water from the foul (waste) water that comes from homes and businesses and protect the Ratby Road area.

### **When and where?**

To hopefully avoid the sort of surprises we found on Leicester Road, we need to do some trial holes on Ratby Road. This will involve us moving along Ratby Road digging a number of holes which will each take around three days to dig, check and backfill.

We'll start on 17 June and expect these trial holes to take two weeks. To keep everyone safe and complete this work quickly we'll be using 2-way and 3-way traffic lights from the junction of Ratby Road/Leicester Road, up the hill to near the Ratby Road Allotments.

During the school summer holidays we'll start replacing the pipes along this same section. We'll write to you again with the detail before that starts and we'll be liaising with the businesses on Ratby Road too.

### **Contact the Severn Trent Team.**

If you have any queries about this work, please speak to the team on site who will help you in any way they can or get in touch with us:

Helen Purdy	07703 718436	<a href="mailto:helen.purdy@severntrent.co.uk">helen.purdy@severntrent.co.uk</a>
Rosie Hunt	07866 001204	<a href="mailto:rosie.hunt@severntrent.co.uk">rosie.hunt@severntrent.co.uk</a>

### **Temporary Traffic Regulation Order, Ratby Road, Groby.**

Leicestershire County Council Highways has agreed to a Temporary Traffic Regulation Order at the above location.

The Temporary Traffic Regulation Order will be implemented for public safety for **STW and their contractors** to undertake investigatory works, as part of a flood alleviation scheme.

Parking restrictions are required on Ratby Road, Groby from the 17th June 2024 for 8 days. The restrictions will be in conjunction with 2 way traffic signals.

During the restrictions, alternative routes available to all traffic can be viewed at <https://one.network/?tm=GB138481849>

### **Part two of Groby Flood Alleviation Scheme, Ratby Road, Groby.**

#### **What are we doing?**

I am pleased to report that Severn Trent is starting work on the Flood Alleviation work on Ratby Road, Groby on the 23 July it will take 7 weeks to complete. I have been working with residents, Highways and Severn Trent over several years to get this work done on both Ratby road and Leicester Road. I am extremely pleased all the hard work has paid off and Severn Trent are carrying out this major improvement to Groby village. The following statement is from Severn Trent.

You know, Groby village has suffered from foul and surface water flooding for several years. We've already installed huge storage pipes on Leicester Road that will hold the excess surface water when it rains heavily and send it slowly back into the waste-water network.

The next phase is to install new pipes that will separate surface water from the foul (waste) water that comes from homes and businesses and protect the Ratby Road area. We're installing new sewer pipes from the junction of Ratby Road/Leicester Road, up the hill to near the Ratby Road Allotments (please see the map below). Work will begin in July so that we can get most of it done at the junction during the school holidays.

#### **Important information**

**Ratby Road will be closed at the Leicester Road junction from 23 July for 7 weeks.** We know this will be a nuisance and we're sorry, but hopefully the benefits of the scheme will be worth it.

- There'll be a signposted diversion in place while the main junction is closed.
- Arriva buses will use a smaller vehicle and divert around Fir Tree Lane, Windmill Rise, Stephenson Way, Martinshaw Lane.
- Vehicle access to Rookery Lane will be via Pymm Ley Lane.
- The Ratby Road car park will remain open but please note the entrance will change.

**Come and find out more**

If you'd like to know more about what's happening, please come along to our drop-in session. We'll be in the Waldrom Room at **Groby Village Hall, Leicester Road, Groby LE6 0DQ on Wednesday 3 July between 3.30pm to 6.00pm**. It's your chance to ask us any questions about the work and for us to find out more

### **Flooding Ratby Road Area**



## Retail Businesses

If you own or operate a business which receives visiting customers who purchase goods or services from you and find that our works are affecting your sales income, then please contact our Business Loss Team - [businessloss@severntrent.co.uk](mailto:businessloss@severntrent.co.uk) for further advice.

Rosie and I will be visiting the businesses in the Ratby Road/Leicester Road area in the next couple of weeks to answer questions.

## Contact us

- If you have any queries about this work, please speak to the team on site who will help you in any way possible or get in touch with us:

Helen Purdy 07703 718436 [helen.purdy@severntrent.co.uk](mailto:helen.purdy@severntrent.co.uk)

Rosie Hunt 07866 001204 [rosie.hunt@severntrent.co.uk](mailto:rosie.hunt@severntrent.co.uk)

- For updates, visit our Planned Improvements webpage at [www.stwater.co.uk/planned-works](http://www.stwater.co.uk/planned-works) and scroll down for 'Groby Flood Alleviation'.

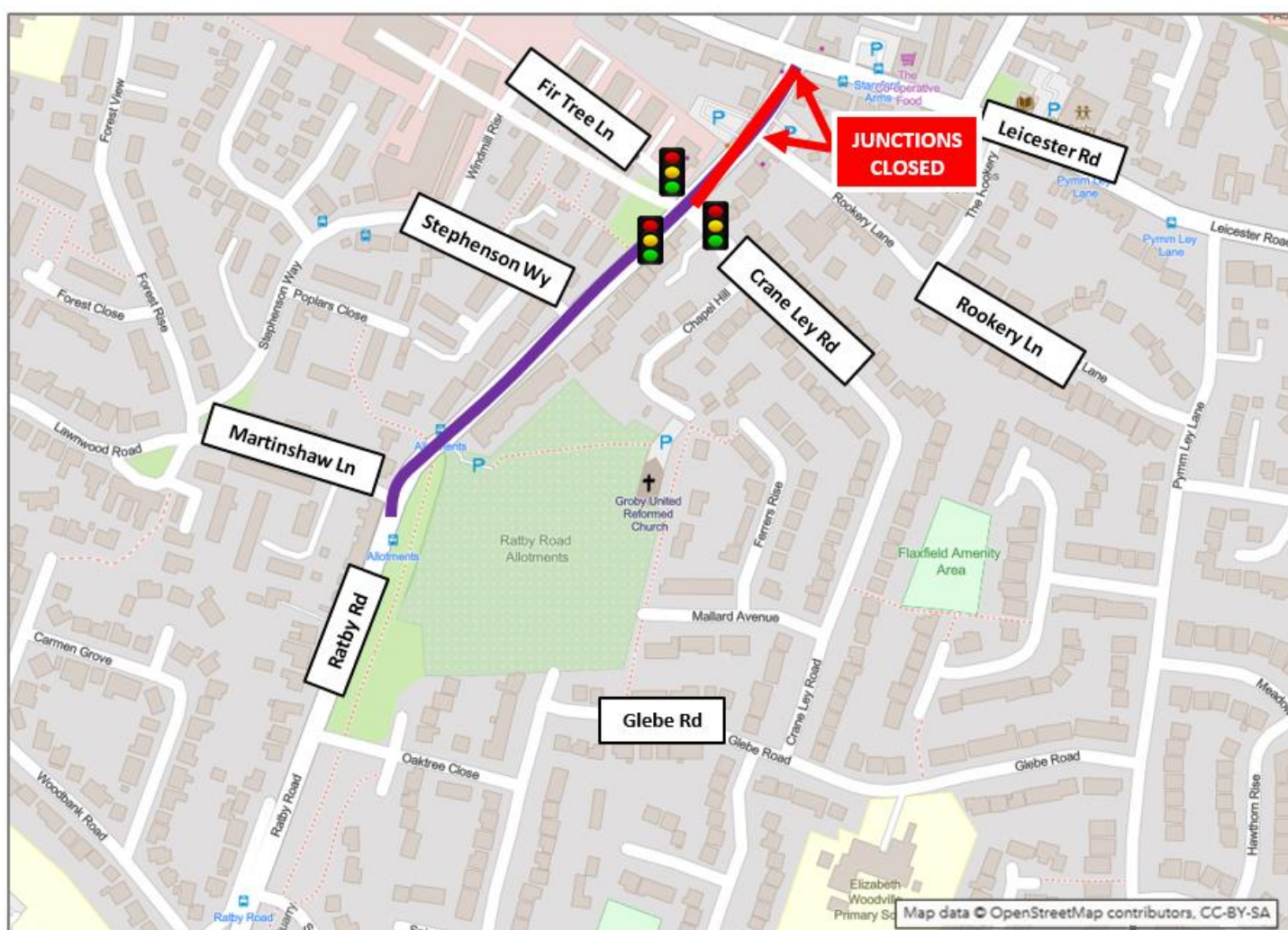

## A message from Market Bosworth Police Beat Team.

This week has seen the start of 'Operation Sceptre' across Leicester, Leicestershire and Rutland. This operation is about education and enforcement, designed to educate young people about the dangers and consequences of carrying a knife; target those who carry weapons and disrupt the sale and supply of knives. If you have concerns about someone carrying a knife, need advice or want further information

about knife crime initiatives you can visit [livesafe.org.uk](https://www.livesafe.org.uk) ([Making our community a safe place to live - LiveSafe](#))

### **Crime Reporting:**

There have been multiple reports received in relation to **Theft from motor vehicles** which have occurred in Market Bosworth this week. It has been reported that entry has been gained and items have been stolen from within one of the vehicles which was left insecure.

Below are some great tips to assist in preventing theft from vehicles:

Fuelling up or popping back into your house to get something are perfect examples of how easy it is to turn your back for a moment and forget your vehicle is unsecured. Getting into the habit of locking your vehicle, even if you're only going to be away from it for a moment, is important.

Your mobile phone, coins for the car park, sunglasses, packs of medication or other items that can earn quick cash are irresistible to the opportunist thief. Remember, the cost of replacing a window is often much more than that of what's stolen. And it should go without saying that wallets, handbags, purses, and credit cards should never be left in an unattended vehicle.

Leaving windows and the sunroof open invites fishing for items through the gap by hand or with, say, a bent coat hanger, which could also be used to unlock a door for them to get in. Thieves can be ingenious. Don't give them the opportunity.

A report of a Burglary has been received, whereby persons have gained entry to a garage by snipping the padlock on a garage door, on doing so, a motocross bike has been stolen. Many people don't secure their shed or garage in the same way they do their homes - often using an easy-to-break lock or padlock to protect valuable contents such as a car, bikes, or lawnmowers.

An opportunistic burglar will try a shed or garage first because they can find the tools they need to break into the main house. Secure your bike to the ground or a lockable stand within a locked shed or garage. Visit **Sold Secure** to search for ground anchors and other locks designed to fix to floors and walls. [www.soldsecure.com](http://www.soldsecure.com)

Additional patrols have been conducted as a result of this, seeing beat officers utilising both late and night shifts in order to provide proactive patrols in and around these areas.

We have been made aware of reports of scam calls being made whereby victims are being telephoned and informed that their bank card may have been cloned. These have been identified as not legitimate and so caution is advised when accepting calls from unknown persons relating to banking/personal information. Further advice is available at [Reporting fraud and cyber crime | Action Fraud](#) whereby you can report fraud or cybercrime to Action Fraud any time of the day or night. Further support can be found at:

#### **Action Fraud**

Members for the public - [0300 123 2040](tel:03001232040) (Monday to Friday, 8am to 8pm)

#### **Action on Elder Abuse (AEA)**

AEA are a national charity working to protect and prevent the abuse of vulnerable older adults. [0808 808 8141](tel:08088088141)

### **Reporting Anti-Social Behaviour:**

As the weather is improving, we have become aware of a rise in reports in relation to Anti-Social behaviour. Residents have been reporting concerns at

Anti-social behaviour includes both criminal and non-criminal behaviour.

This could be:

**Threatening, harassing or unruly behaviour such as drunkenness and loitering in public spaces.**

**Alcohol related nuisance / drug use – and the mess and disruption that can go with it.**

**Vandalism, graffiti, fly-tipping, and littering.**

**Abandoned vehicles.**

**Disruptive neighbours consistently playing loud music or letting their dog bark all night.**

When reporting incidents of this type. Please call 101 to report a non-emergency incident to the police. You can also report antisocial behaviour at [www.leics.police.uk](http://www.leics.police.uk) or through the Hinckley & Bosworth Borough Council website [www.hinckley-bosworth.gov.uk](http://www.hinckley-bosworth.gov.uk).

Please continue to enjoy the wonderful weather whilst it lasts! Stay Safe, thank you and take care.

Finally, I would also like to thank you all for your continued support and remind you that should you need my help or advice, I always pride myself on making myself available to residents. Remember I am only a phone call or email away.

*Ozzy O'shea.*

*Always Working for you Locally.*

Cllr Ozzy O'shea Tel 0116 2394336 Mobile 07808585825

Email [Ozzy.O'shea@leics.gov.uk](mailto:Ozzy.O'shea@leics.gov.uk)

Email [ozzyoshea@hotmail.com](mailto:ozzyoshea@hotmail.com)

